

## Chemola™ Delta "A" Series Capped Vent Fitting

**Chemola™ Delta A Series** is a precision-made standard body fitting for gate, ball and plug valves. It features a long-thread body and deep seating. This fitting is also a spring loaded, single check valve.

### Materials

Component	Material
	Low-carbon steel
	Zinc with dichromate
	Chrome alloy
	302 SS

### Ordering Information

Item Number	Unit Size
	1/4" NPT thread
	3/8" NPT thread
	1/2" NPT thread

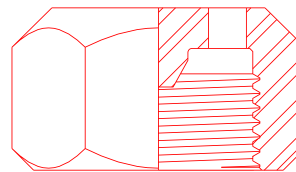

VENT CAP,  
1-1/4" HEX

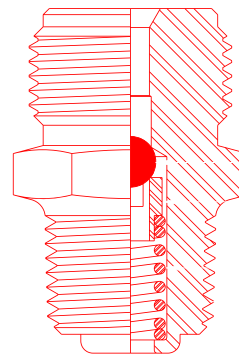

1"-14 UNS

BALL

1" TO 1-5/16"  
WRENCH HEX

POSITIVE FLOW  
BALL SUPPORT

SPRING

1/4" TO 1"  
NPT THREAD

HEAVY-DUTY  
RADIAL RIVET  
CRIMP

*Also available in stainless steel.  
Additional sizes available.*